

A Project by



SVRS Infra Projects
A NAME YOU CAN TRUST



Member of
CREDAI
Confederation of Real Estate
Developers Association of India

*Welcome to a
Home filled with
Happiness and Peace !*

LUXURY DUPLEX
3 BHK HOMES



S.V.R.S.
lifestyle

@ NH-44, Adj. to Sakshi PaperPress, Ananthapur

S.V.R.S.
lifestyle

@ NH-44, Adj. to Sakshi, Anantapur



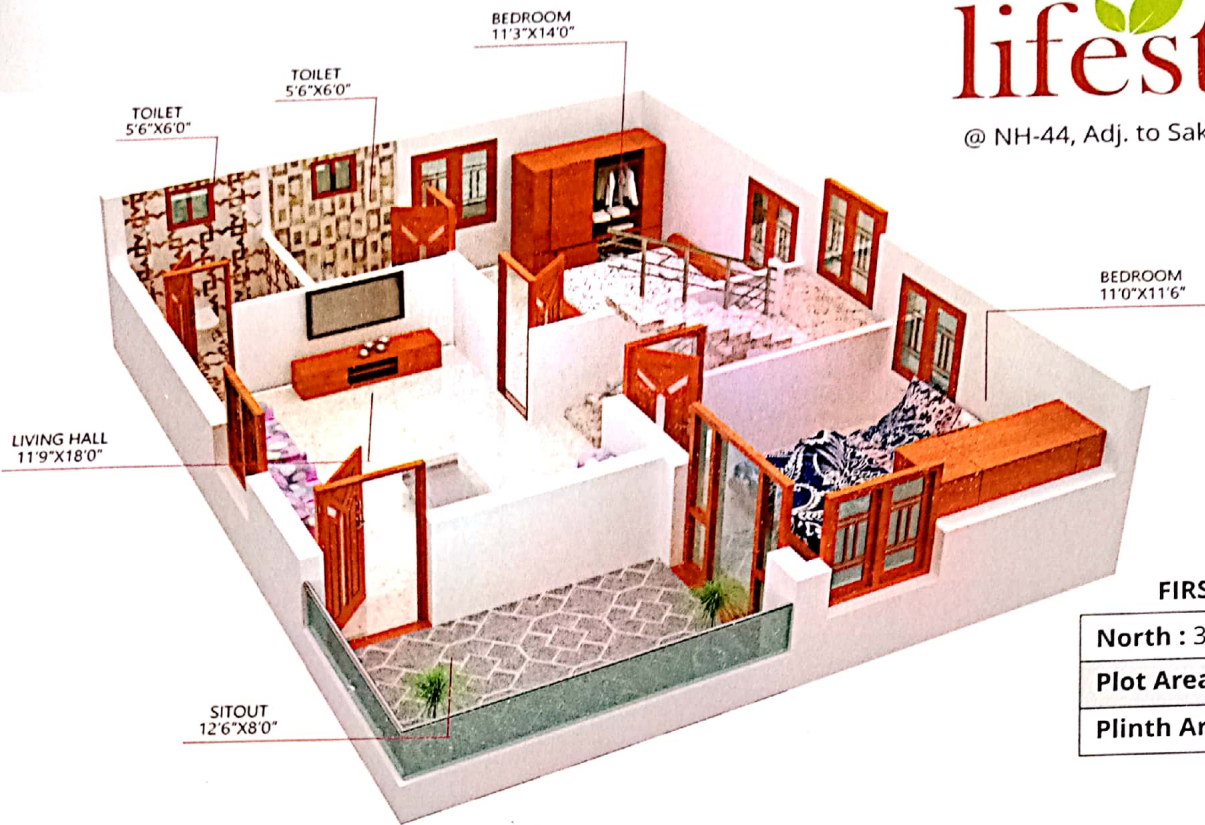

FIRST FLOOR

North : 33' x 40'

Plot Area : 1320 Sq. Ft.

Plinth Area : 850 Sq. Ft.

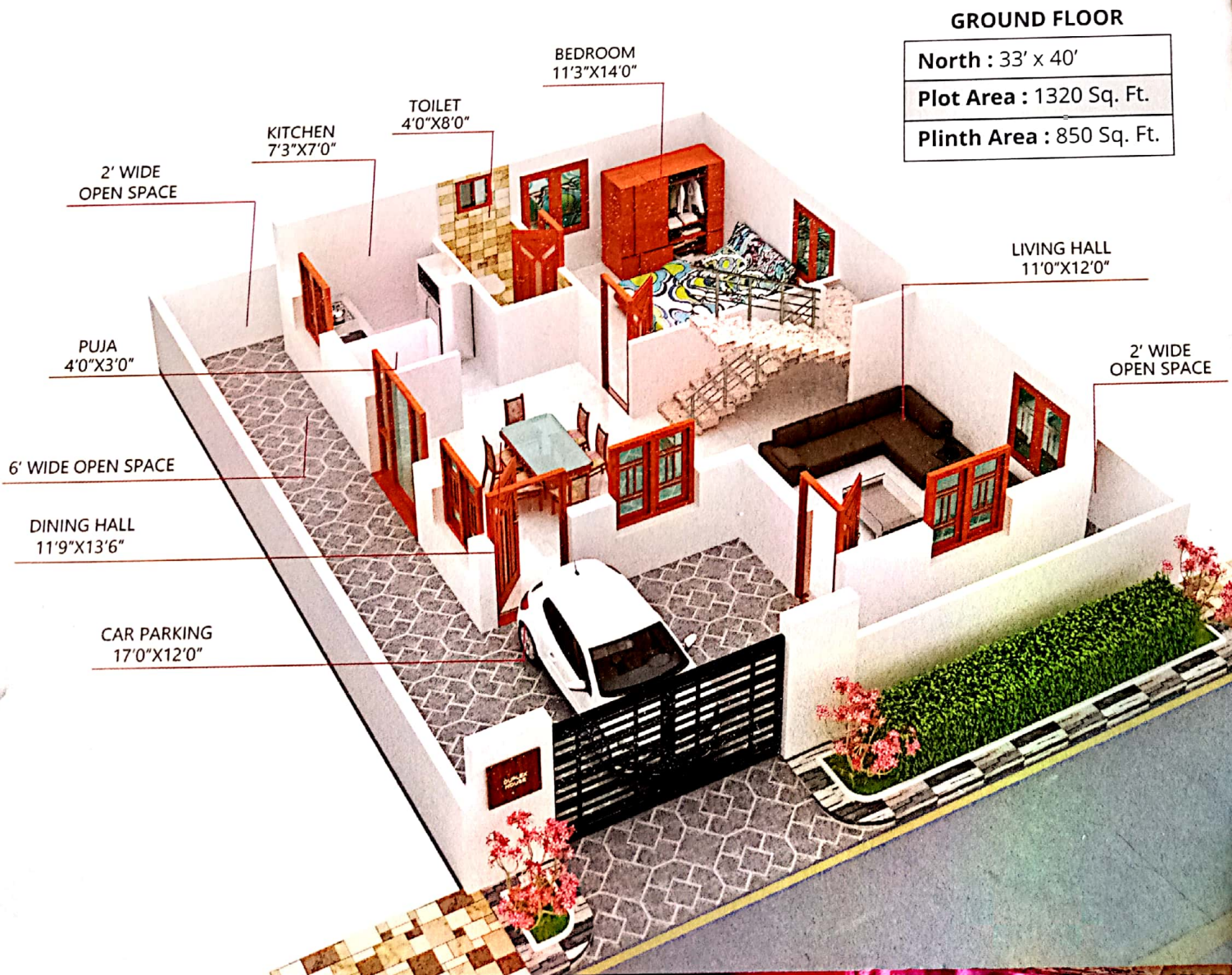

GROUND FLOOR

North : 33' x 40'

Plot Area : 1320 Sq. Ft.

Plinth Area : 850 Sq. Ft.

SPECIFICATIONS



Foundation & Structure

- RCC Framed structure designed to with standard as per structural design



Plastering

- Sponge finish plastering in CM



Other Doors & Windows

- C.T. Wood frame with standard flush door shutter & UPVC windows with reputed make hardware of SS



Kitchen

- Black -granite platform with stainless steel sink



Living

- Wash Basin in Living Hall



Tile Cladding & Dadoing

- Glazed ceramic tiles dado up to 2' height above the kitchen platform



Toilets - Tiles

- Designer glazed ceramic tiles dado upto door height
- All CP fittings of standard make



Toilets

- EWC of ISI or equivalent for Master Bedroom & other with Indian style commode
- Hot & cold single lever mixer with shower in attach Bathroom



Painting

- Internal : Two coats of acrylic emulsion paint. Asian or equivalent brand over Birla wall care putty/JK / Berger Wall Putty Total Walls Except Bathrooms, Cement Shelves & Kitchen
- Exterior : Texture Paint for Elevation Side.



Additional

- Any additional works are considered subject to feasibility at extra cost.



Superstructure

- Red brick masonry in cement mortar



Wood Work : Main Door

- Best teak wood frame with teak wood shutter finished with polish fixed with reputed make hardware of brass



Grills

- M.S. Grills for windows with enamel painting and mosquito mesh.

Flooring

- Tiles of reputed make 2'x2'
- Best quality acid-resistant and anti-skid ceramic tiles of standard make in toilets
- Wooden Flooring for Master Bedroom



Water Supply

- Water Sump, Water Supply of 1000 ltrs. of Sintex / Equivalent Make Water Tank



Cupboards

- Cement Shelves for 3 BHK Independent Houses

Electrical & Cable T.V.

- 3-Phase supply for each unit and individual meter boards
- Concealed copper wiring of standard make of Anchor / Polycab or equivalent
- Power Outlet for Air-conditioner in 3 Bedrooms and living area.
- Power Outlet for Geysers in Master Bathroom
- Power Plugs in all necessary areas as per drawing
- Plug point for TV & Telephone in Hall
- Provision for cable connection in Hall



S.V.R.S.
lifestyle

Note : 1) Government Taxes (GST and other) , Electrical Connection, Municipal Water Connection, Registration Charges, House Approval and any other Government Charges are to be paid by the Individual Plot Owner.

Project Amenities

- Childrens Play Area
- Multipurpose Hall
- Gymnasium
- Designer Street Lamps
- Black Top Roads
- Drainage Facility
- 100 % Vaasthu Compliant
- Compound Wall
- Strategic Location
- 24 x 7 Security & Avenue Plantation
- Premium Quality Construction
- Excellent Ventilation
- Earth Quake Resistant Design
- Housing Loan Facility



*Welcome to a Home filled with
Happiness and Peace !*

S.V.R.S.
lifestyle
@ NH-44, Adj. to Sakshi, Anantapur

Location Highlights

- Adjacent to Sakshi Publications

Nearby Schools :

- Sri Chaitanya School
- AGS School
- St. Thomas IIT School

Nearby Colleges :

- SLN Junior College
- Vani Degree College

Nearby Hospitals :

- Savera Medical Center

Nearby Restaurants :

- Hyway Lounge
- Spice Garden
- Red Pepper
- Near to IV Town Police Station
- Ad. to Bangalore Highway NH-44



**Sri Chaitanya
Techno School**